



xsign™

World Trade Centre - Bahrain
architect: Atkins
signs supplied 2007

Minsheng Bank HQ - Wuhan, China
architect: Wuhan Architectural Design Institute
signs supplied 2007

dline^xsign ltd.

has manufactured its products in the UK since its creation in 1999.

Once part of the Danish ironmongery company **dline**, we were the first manufacturer in the world to launch a secret-fixed stainless steel modular sign system in 2000, based on the **Jigsaw**™ fixing system designed by British architect Mark Shaw-Smith.

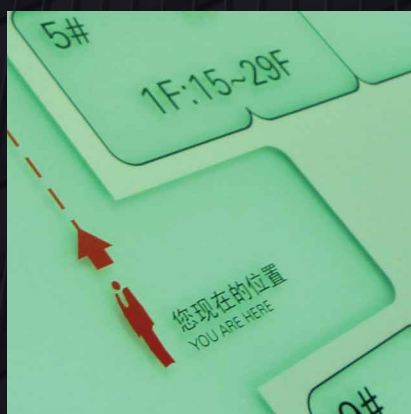

innovation

So many unique materials and texting methods flow from a deeply technical approach to sign design and manufacturing, including indelible lasered text from powdered glass or new materials such as polished concrete and bronze foil.

Unique processes include Multi-Metal printing which changes the surface properties of metal to create a unique and permanent graphic expression.



Central Bank of Kuwait

architect: HOK

signs supplied 2015

global partner

As a preferred partner on some of the world's highest profile buildings, we have proven expertise in wayfinding, sign design, manufacturing and project management.

The company has experience of exporting signs to more than forty countries and has a supportive international outlook.

Numerous clients have selected **xsign™** products for use across their international office locations enjoying local support and centralised brand consistent manufacturing.



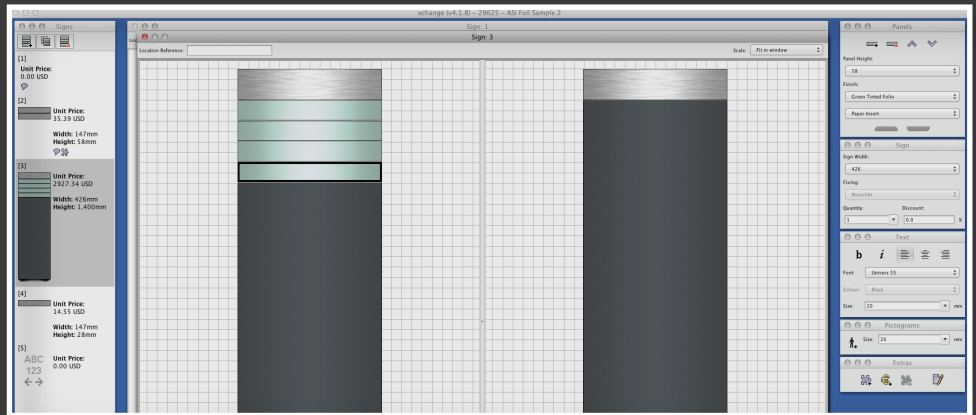
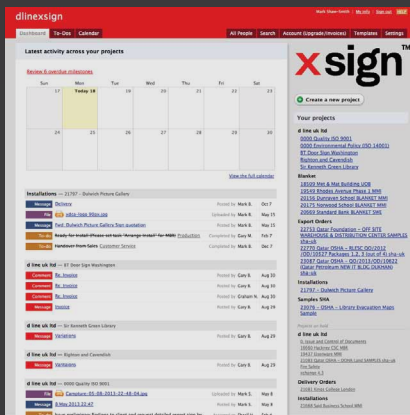

xchange

Integrated systems in quotation, project management, manufacturing and individual task tracking from start to finish.

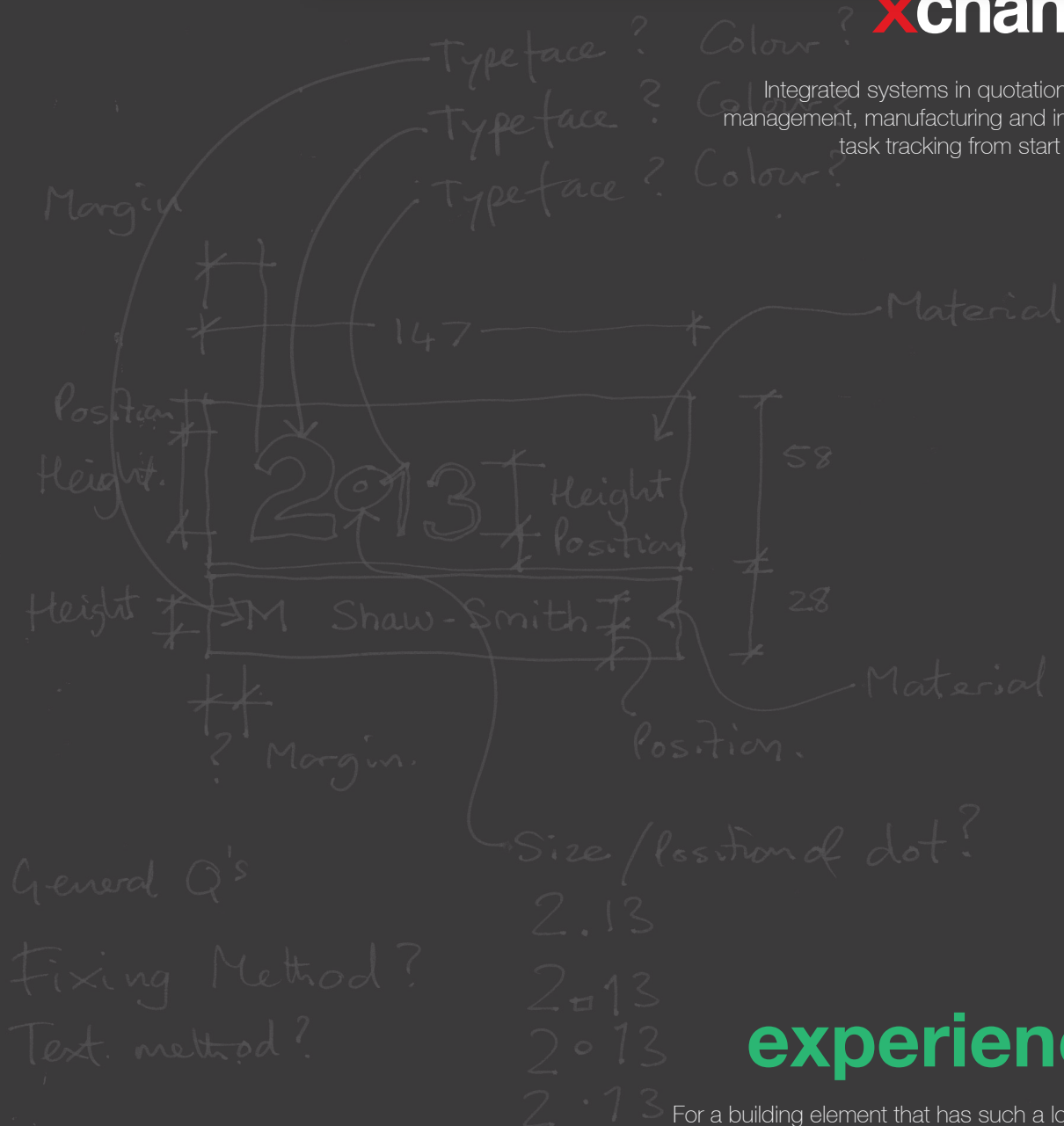

experience

For a building element that has such a low value, signage is one of the most difficult construction packages to manage with numerous decision makers.

All processes must be extremely robust therefore to ensure that error creep is removed and deliverables are PERFECT first time.

Our experience in handling large complex signage projects has allowed us to develop effective and sophisticated project management tools.

corporate

A key partner for large blue chip companies since 1999.

Canary Wharf London

projects include signs for:

Clifford Chance HQ - Gensler

Reuters HQ - Kohn Pedersen Fox/Perkins & Will

McGraw Hill HQ - HLW

Barclays Bank HQ - Conran & Partners

One Canada Square - Various

Moodys - Swanke Hayden Connell

MetLife - Perkins & Will

ConocoPhillips - Lees Associates

products

We constantly review and invest in new technologies and offer high value and high quality products for all aspects of sign needs.

custom



interior

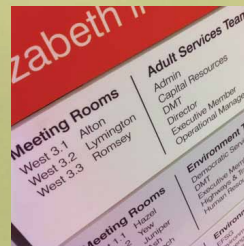



exterior



graphics



culture

Our company is owned and headed by British architect Mark Shaw-Smith and all **dline™** and **xsign™** products are architect designed.

Integral to the design process we consider the needs of installers, contractors and facilities teams to keep the signs fresh and easy to handle.

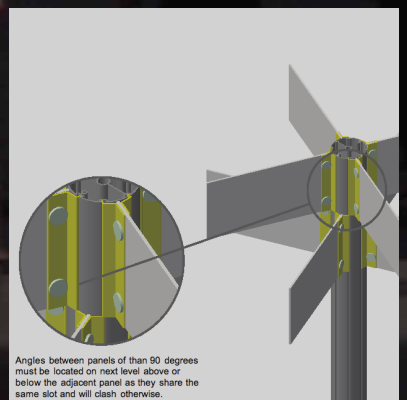
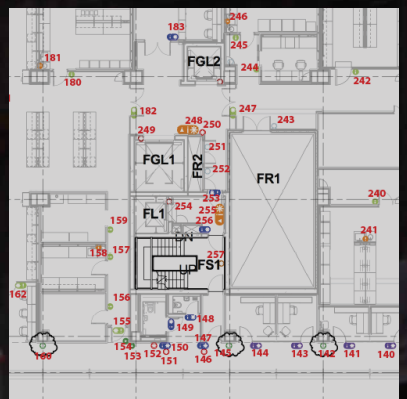
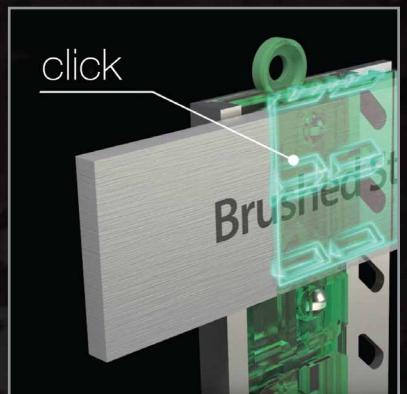
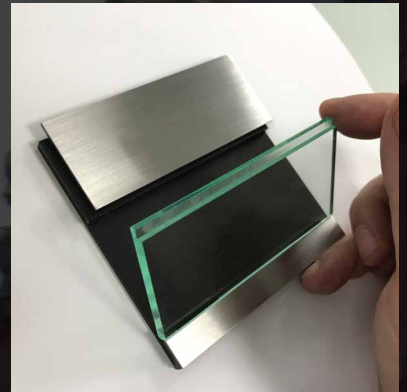

Marsh HQ - London
architects: Foster and Partners & Gensler
signs supplied 2002

One Hyde Park - London

The World's Most Expensive Residential Building
architect - Rogers Stirk & Harbour
signs supplied 2010

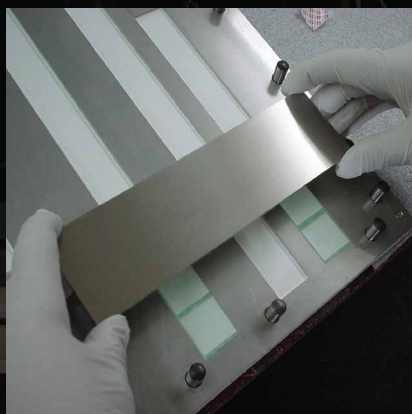

quality

A critical approach to continual improvement has lead to ISO 9001 and 14001 certification.

We creatively examine ways of working and often invent new tools to achieve quality.

In house installation teams help us to offer true turn key solutions and to incorporate the needs of the final end user into the product design.

Qatar University Campus - Doha

architect: Kamal El-Kafrawi

signs and wayfinding supplied 2011–2012

consultancy

Experience in sign design also includes WAYFINDING and signing strategies for complex hospitals and university campuses.

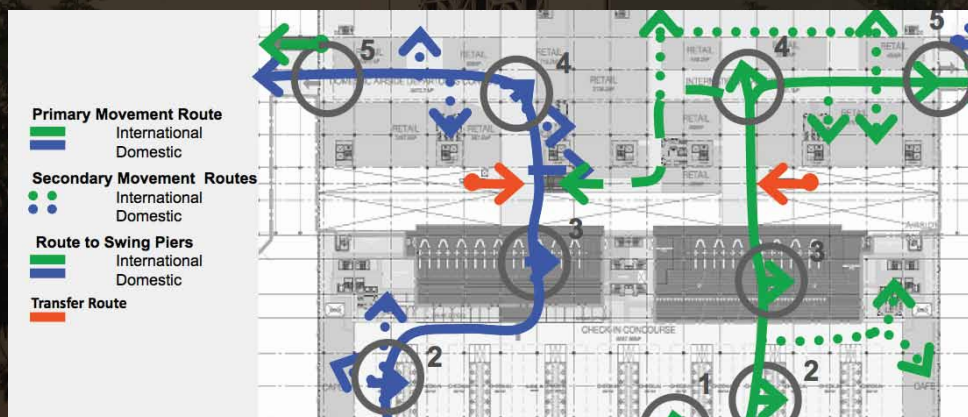

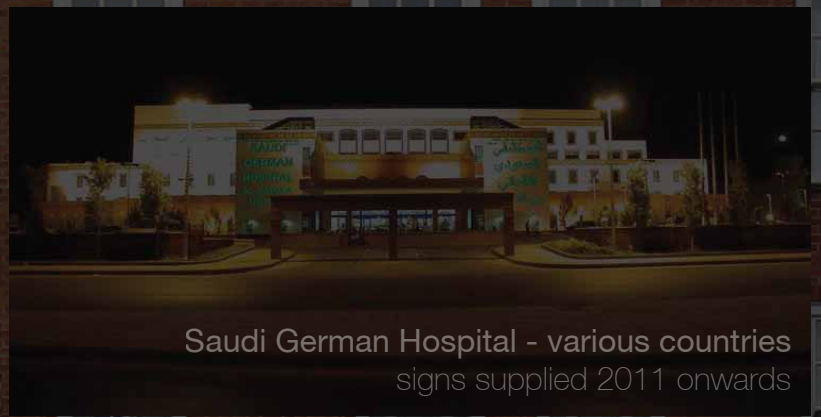

Saudi German Hospital - various countries
signs supplied 2011 onwards

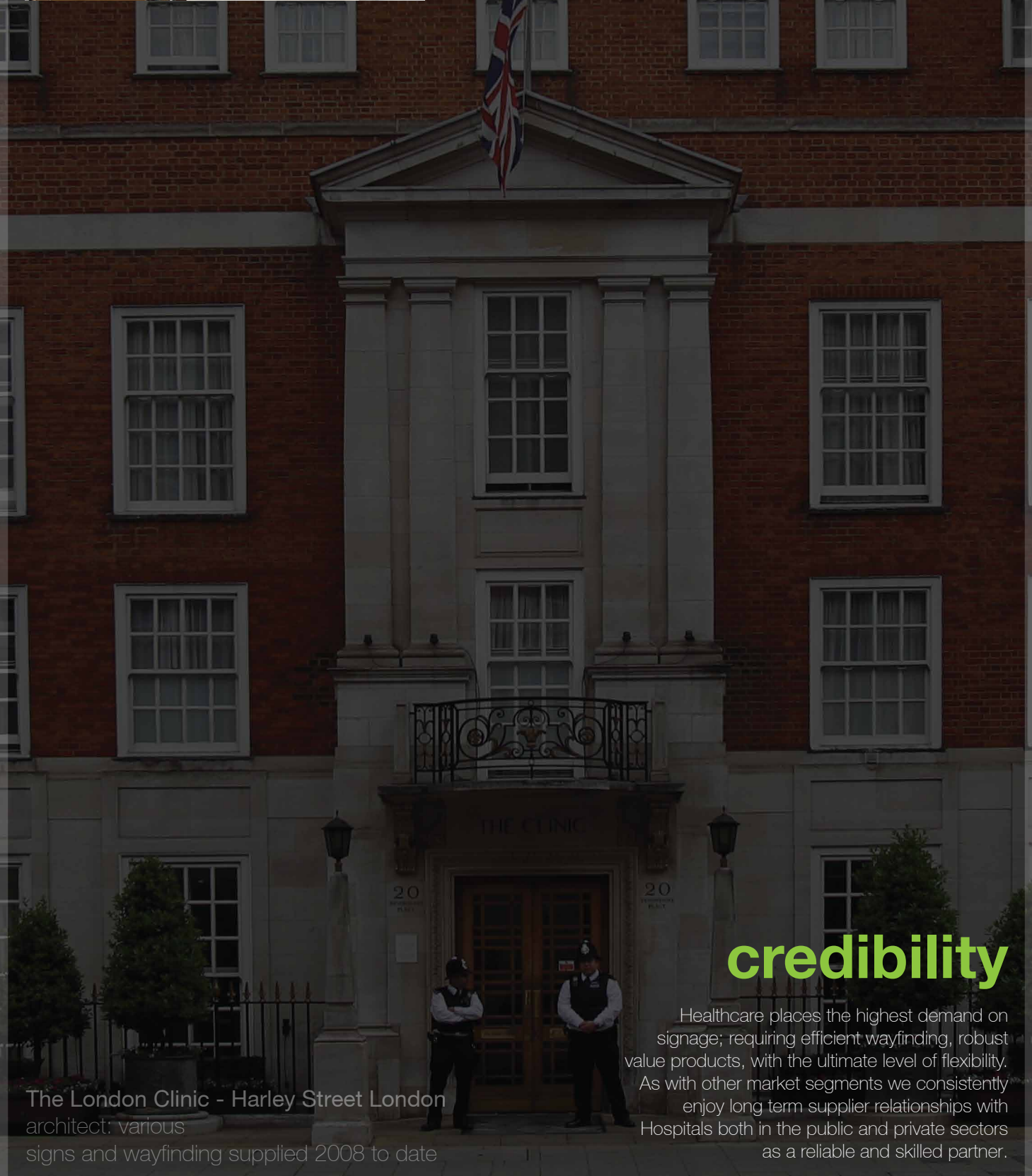

The London Clinic - Harley Street London
architect: various
signs and wayfinding supplied 2008 to date

credibility

Healthcare places the highest demand on signage; requiring efficient wayfinding, robust value products, with the ultimate level of flexibility. As with other market segments we consistently enjoy long term supplier relationships with Hospitals both in the public and private sectors as a reliable and skilled partner.



dlinexsign ltd.

manufacturing and headquarters

Unit A Shires Road
Brackley
Northants
NN13 7EZ
United Kingdom

+44 (0) 1280 841200
info@xsign.com

Almas Tower - Dubai
architect: Atkins Middle East
signs supplied 2008

www.xsign.com

rev 2